



COMING FROM :

LONDON
OOSTENDE (A10 / E 40)
GENT (A10 / E 40)
ANTWERPEN (A12)

FOLLOW :

* ZAVENTEM  
* DIEGEM-INDUSTRIE 

COMING FROM :

AMSTERDAM
ANTWERPEN

FOLLOW :

* A1 / E19
* ZAVENTEM  
* DIEGEM-INDUSTRIE 

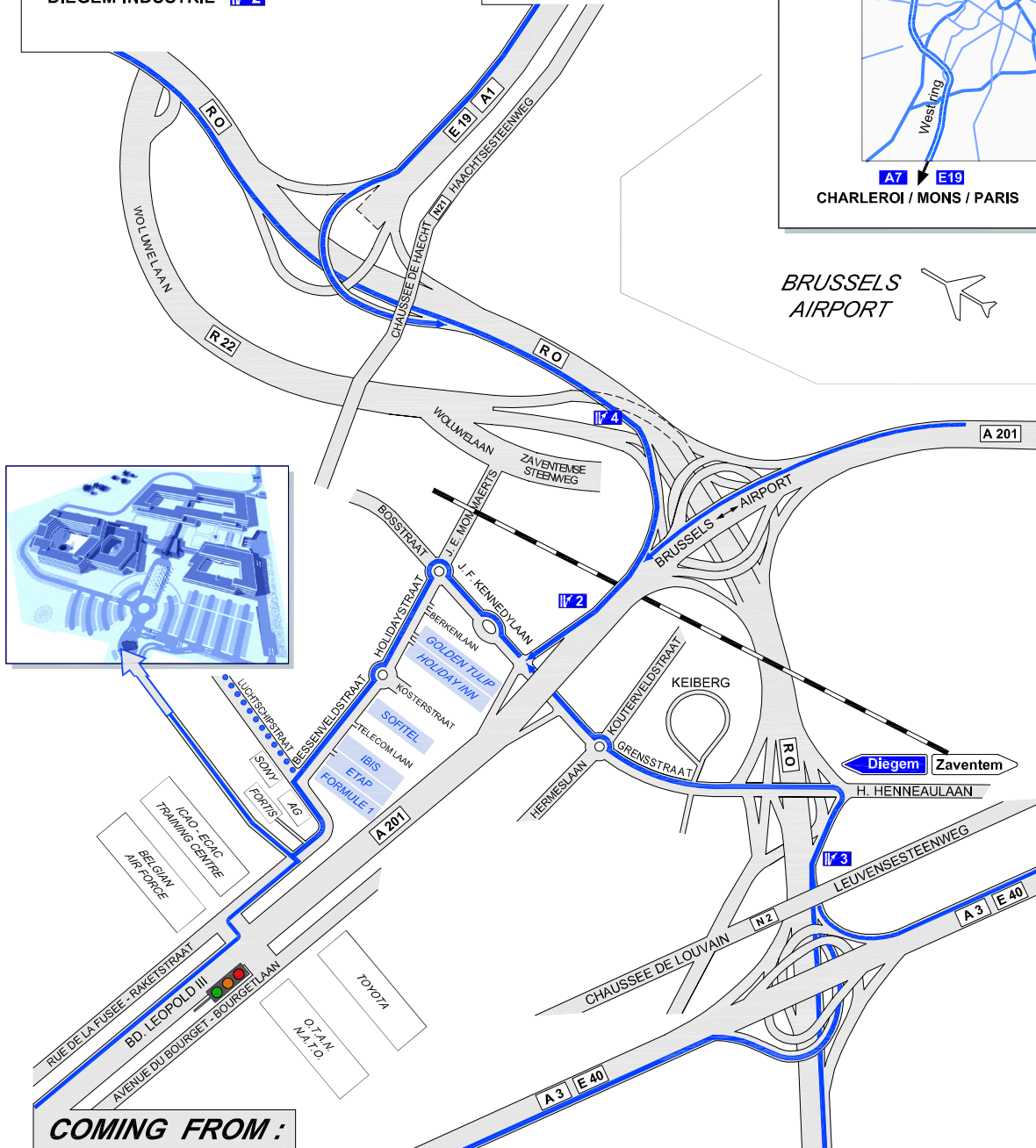
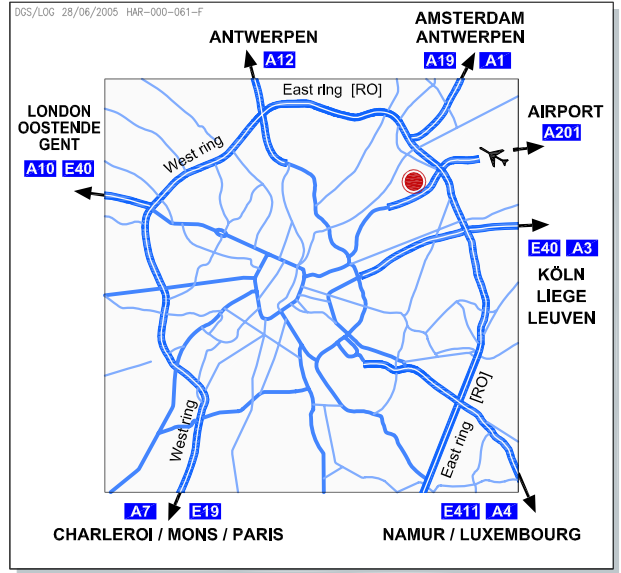

COMING FROM :

AIRPORT (A201)

FOLLOW :

* BRUSSELS
* DIEGEM-INDUSTRIE 

COMING FROM :

KÖLN (A3 / E40)
LIEGE
LEUVEN

FOLLOW :

* ZAVENTEM 
* DIEGEM-INDUSTRIE 

COMING FROM :

BRUSSELS CITY



FOLLOW :

* ZAVENTEM 
* TURN LEFT AT NATO HEADQUARTERS TRAFFIC LIGHTS

COMING FROM :

BRUSSELS CITY (A3 / E40)



FOLLOW :

* ZAVENTEM 
* DIEGEM-INDUSTRIE 

COMING FROM :

PARIS / MONS (A7 / E19)
LUXEMBOURG / CHARLEROI

FOLLOW :

* ZAVENTEM 
* DIEGEM-INDUSTRIE 



EUROCONTROL

RUE DE LA FUSEE , 96
1130 BRUXELLES (HAREN)
Tel. : (0032) 2 729 90 11

